



*Innovation from cell to society • Innovation de la cellule à la société*

## **2013 SCIENTIFIC MEETING**

**KINGBRIDGE CONFERENCE CENTRE & INSTITUTE  
KING CITY, ONTARIO  
JUNE 7-10, 2013**

## ALLERGEN NCE 2013 SCIENTIFIC MEETING

### **AllerGen's Vision:**

To create an enduring network of allergy and immune disease experts whose discovery and development efforts contribute to reductions in the impact of allergic and related immune diseases nationally and globally.

### **AllerGen's Mission:**

To catalyze and support discovery, development, networking, capacity building, commercialization and knowledge translation to reduce the morbidity, mortality and socio-economic burden of allergy, asthma and anaphylaxis for the benefit of Canadians and the global community.

## ALLERGEN NCE 2013 SCIENTIFIC MEETING

### Welcome from Allergen's Scientific Director and Managing Director

On behalf of Allergen NCE, we welcome you to the 2013 Scientific Meeting at the Kingbridge Conference Centre & Institute in King City, Ontario.

In March 2012, following 18 months of stakeholder consultation, and extensive strategic and operational planning, Allergen was successfully renewed through to 2019. We thank each of you for your contribution, commitment and collaboration throughout the renewal process.

This is Allergen's first Scientific Meeting since the Network's founding in 2005. This year, it replaces the Allergen Annual Conference and shines a spotlight on scientific exchange, which we hope will catalyze new ideas, new commercialization opportunities, new strategies to influence public policy, and new collaborations to further integrate our research teams across our key Legacy Projects and Enabling Platforms.

As the last remaining NCE of the "classic" 7+7 funding model, we now focus on ensuring that Network results translate into better health, improved quality of life, and new tools and technologies to sustain Canadian jobs and productivity for the long term.

Over the next several days, we look forward to hearing how the research projects outlined in the 2012-2019 Strategic Plan have been brought to life and will collectively contribute to reducing the morbidity, mortality and socio-economic burden of allergy, asthma and anaphylaxis for the benefit of Canadians and the global community.



**Dr. Judah Denburg**



**Dr. Diana Royce**



**South Wing**

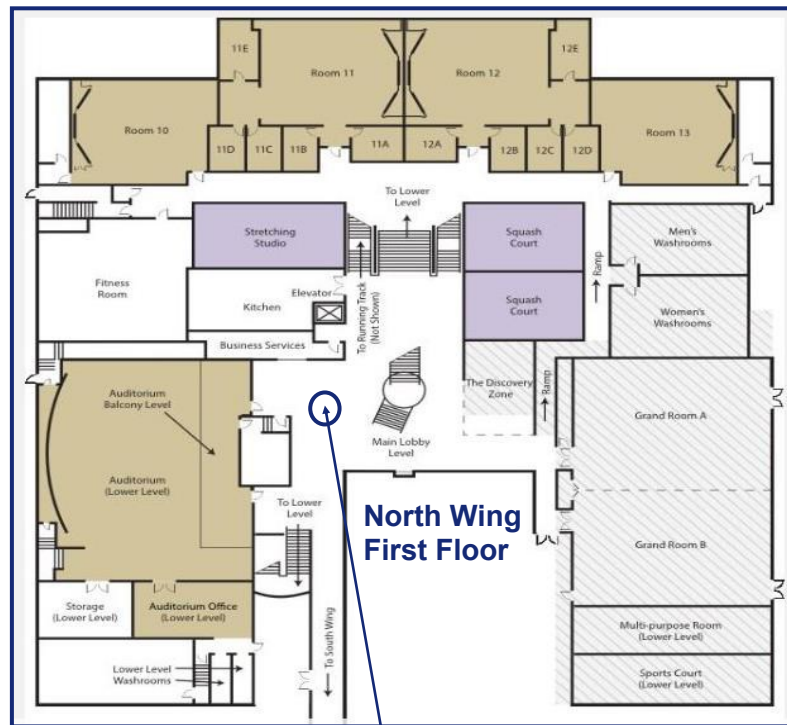

**North Wing  
First Floor**

**AllerGen Registration Desk**

**Kingbridge Conference Centre Floor Plan**  
12750 Jane Street, King City, Ontario L7B 1A3

**Main Desk: (905) 833-6521**

**FRIDAY, JUNE 7, 2013**

<b>MAIN LEVEL LOBBY</b> <b>4:30-8:00 pm</b>	<b>REGISTRATION</b>
<b>5:30-7:00 pm</b>	<b>DINNER</b>
	<b>CONNECTIONS DINING ROOM</b>
<b>BRIDGES BAR (Cash bar)</b> <b>7:00-9:00 pm</b>	<b>MEET AND GREET</b>



AllerGen's 2013 Scientific Meeting is supported by the Canadian Institutes of Health Research (CIHR).

AllerGen extends its appreciation to its 177 Network Partners across Canada for their ongoing support of the 112 investigators and 427 trainees actively engaged in Network research, commercialization and knowledge mobilization initiatives.

SATURDAY, JUNE 8, 2013

7:30-8:30 am		BREAKFAST	CONNECTIONS DINING ROOM
<b>AUDITORIUM</b> 8:45-9:05 am	<b>WELCOME REMARKS</b> <b>J. Denburg</b> , MD, FRCP (C), Scientific Director and CEO, AllerGen NCE Inc.; Professor of Medicine, Department of Medicine, McMaster University		
9:05-9:20 am	<b>MEETING OBJECTIVES</b> <b>D. Royce</b> , EdD, Managing Director and COO, AllerGen NCE Inc.		
<b>AUDITORIUM</b>	<b>THE CANADIAN FOOD ALLERGY STRATEGIC TEAM (CanFAST)</b>		
9:20-9:35 am <b>LEAD PRESENTATION</b>	<b>THE CanFAST TEAM: EVOLUTION AND CURRENT FOCI</b> <b>J. Marshall</b> , PhD, Professor and Head Microbiology and Immunology, Dalhousie University <b>A. Clarke</b> , MD, Professor, Division of Clinical Immunology, McGill University		
9:40-10:30 am	<b>PANEL A1: FOOD ALLERGY AND PREVALENCE, CAUSES AND TOLERANCE</b>		
CanFAST1	<b>SURVEYING THE PREVALENCE OF FOOD ALLERGY IN ALL CANADIAN ENVIRONMENTS-TRENDS OVER TIME (SPAACE TO SPAACE)</b> <b>A. Clarke</b> , MD, Professor, Division of Clinical Immunology, McGill University <b>S. Elliott</b> , PhD, Professor and Dean, Faculty of Applied Health Sciences, University of Waterloo		
CanFAST3	<b>A CROSS-CANADA ANAPHYLAXIS REGISTRY (C-CARE)</b> <b>M. Ben-Shoshan</b> , MD, McGill University Health Centre		
CanFAST2	<b>CAUSES AND PREVENTION: IDENTIFYING THE GENETIC BASIS OF PEANUT ALLERGY</b> <b>Y. Asai</b> , MD, M.Sc., FRCPC, Assistant Professor of Medicine, McGill University		

9:40-10:30 am	<b>PANEL A1: FOOD ALLERGY AND PREVALENCE, CAUSES AND TOLERANCE</b>	
CanFAST4	<b>DISEASE MODULATION CLINICAL TOLERANCE STUDY</b> <b>B. Mazer</b> , MD, Associate Professor, McGill University Health Centre; Director, Division of Allergy and Immunology, Montréal Children's Hospital	
CanFAST5	<b>STRATEGIES FOR ENHANCING TOLERANCE INDUCTION: PRECLINICAL STUDIES AND CHILD LINKED PROJECT DEVELOPMENT</b> <b>J. Marshall</b> , PhD, Professor and Head Microbiology and Immunology, Dalhousie University	
10:30-11:00 am	<b>BREAK</b>	
11:00-11:20 am	<b>PANEL A2: FOOD ALLERGY AND PREVALENCE, CAUSES AND TOLERANCE</b>	
CanFAST6	<b>PREVENTING SEVERE REACTIONS-PRECLINICAL STUDIES</b> <b>J. Gordon</b> , PhD, Professor, Department of Veterinary Microbiology, University of Saskatchewan	
CanFAST7	<b>DISEASE MANAGEMENT: CANADIAN PEANUT THRESHOLDS STUDY</b> <b>S. Waserman</b> , MD, M.Sc., FRCPC, Professor of Medicine, Division of Clinical Immunology and Allergy, McMaster University; Director of Adverse Reactions Clinic, Firestone Institute for Respiratory Health, St. Joseph's Hospital	
11:20-12:15 am	<b>GENERAL DISCUSSION</b> Impacts, networking, partnerships, collaborations, legacy opportunities	
12:15-1:30 pm	<b>LUNCH</b>	<b>CONNECTIONS DINING ROOM</b>

AUDITORIUM	THE CANADIAN HEALTHY INFANT LONGITUDINAL DEVELOPMENT (CHILD) STUDY
1:45-2:00 pm <b>LEAD PRESENTATION</b>	<b>THE CANADIAN HEALTHY INFANT LONGITUDINAL DEVELOPMENT (CHILD) STUDY: EVOLUTION AND CURRENT FOCI</b> <b>M. Sears</b> , MB, ChB, FRACP, FRCPC, FAAAAI; Director, Canadian Healthy Infant Longitudinal Development (CHILD) Study; AstraZeneca Chair in Respiratory Epidemiology; Professor, Division of Respiriology, Department of Medicine, McMaster University
2:05-3:00 pm	<b>PANEL B: CHILD SUB-STUDIES</b>
CHILD	<b>FOCUS ON RETENTION OF CHILD SUBJECTS: THE VANCOUVER APPROACH</b> <b>S. Turvey</b> , MBBS, DPhil, FRCPC, Associate Professor, Department of Pediatrics, University of British Columbia <b>C. Lepine</b> , BA, Research Assistant, CHILD Study, Child & Family Research Institute, University of British Columbia
CHILD	<b>CHILDHOOD SLEEP DISORDERED BREATHING</b> <b>P. Mandhane</b> , MD, PhD, FRCPC, Assistant Professor, Paediatric Respiratory Medicine, University of Alberta
CHILD	<b>PERFLUORINATED COMPOUNDS</b> <b>A. Becker</b> , MD, PhD, FRCPC, Professor and Head of the Section of Allergy & Clinical Immunology, Department of Pediatrics & Child Health, University of Manitoba
CHILD	<b>PULMONARY FUNCTION AND RESPIRATORY TRACT INFECTIONS</b> <b>P.J. Subbarao</b> , MD, M.Sc., FRCP (C), Assistant Professor, Department of Paediatrics, University of Toronto; Staff Respiriologist, The Hospital for Sick Children
CHILD	<b>HARMONIZATION OF BIRTH COHORTS FOCUSING ON MATERNAL AND CHILD HEALTH</b> <b>S. Anand</b> , MD, PhD, FRCP(C), Professor, Department of Medicine, McMaster University; Director, Population Genomics Program; Director, Vascular Medicine Clinic, Hamilton Health Sciences
3:00-3:30 pm	<b>GENERAL DISCUSSION</b> Impacts, networking, partnerships, collaborations, legacy opportunities



3:30-4:00 pm		BREAK	
AUDITORIUM	GENE-ENVIRONMENT (GxE) ENABLING PLATFORM		
4:00-4:15 pm LEAD PRESENTATION	EXAMINING THE ROLE OF GENES AND GENE-ENVIRONMENT INTERACTIONS: THE NEED FOR THE GXE ENABLING PLATFORM J. Brook, PhD, Assistant Professor, Occupational and Environmental Health, University of Toronto; Senior Scientist, Air Quality Research Branch, Environment Canada		
4:20-5:00 pm	PANEL C: DISEASE MANAGEMENT		
GxE3	ALLERGY-BRAIN CONNECTION (ABC) RESEARCH TEAM N. Letourneau, PhD, RN, Professor, Faculty of Nursing, University of Calgary; Norlien/ACHRI Chair in Parent-Infant Mental Health		
GxE1	BETTER EXPOSURE AVOIDANCE MEASURES (BEAM) AND NEW ENVIRONMENTAL SENSOR TOOL DEVELOPMENT J. Brook, PhD, Assistant Professor, Occupational and Environmental Health, University of Toronto; Senior Scientist, Air Quality Research Branch, Environment Canada		
GxE2	RAPID ENVIRONMENTAL EFFECTS ON GENES: THE LENS OF EPIGENETICS (REEGLE) M. Kobor, PhD, Associate Professor, University of British Columbia		
GxE4	STRENGTHENING THE CASE FOR ONGOING REDUCTION OF EXPOSURE TO TRAFFIC-RELATED AIR POLLUTION (SCORE-TRAP) C. Carlsten, MD, MPH, Assistant Professor, University of British Columbia		
5:00-5:30 pm	GENERAL DISCUSSION Impacts, networking, partnerships, collaborations, legacy opportunities		
6:30-7:30 pm		DINNER	CONNECTIONS DINING ROOM
7:30-9:00 pm		BONFIRE SOCIAL	LIBRARY/OUTDOOR PATIO

SUNDAY, JUNE 9, 2013

8:30-9:30 am	BREAKFAST	CONNECTIONS DINING ROOM
AUDITORIUM	PATIENTS, POLICY AND PUBLIC HEALTH ENABLING PLATFORM	
9:45-10:45 am	PANEL D: KNOWLEDGE TRANSLATION AND MOBILIZATION	
PPP1	<b>TECHNOLOGY-ENABLED KNOWLEDGE TRANSLATION AND MOBILIZATION</b> <b>A. Levinson</b> , MD, FRCPC, Assistant Professor and Director, Division of e-Learning Innovation, McMaster University	
PPP5	<b>DEVELOPMENT OF AN EVIDENCE-BASED CERTIFIED ALLERGY EDUCATOR PROGRAM</b> <b>A. Becker</b> , MD, PhD, FRCPC, Professor and Head of the Section of Allergy & Clinical Immunology, Department of Pediatrics & Child Health, University of Manitoba	
PPP3	<b>THE PLATFORM FOR OUTCOMES RESEARCH AND TRANSLATION IN ASTHMA AND ALLERGY (PORTAL)</b> <b>L. Lynd</b> , PhD, Associate Professor, University of British Columbia; Associate Director of the Collaboration for Outcomes Research and Evaluation (CORE)	
PPP4	<b>WHITE PAPER SERIES</b> <b>S. Burningham</b> LLB, BCL, Research Associate, Health Law and Science Policy Group, University of Alberta	

9:45-10:45 am	<b>PANEL D: KNOWLEDGE TRANSLATION AND MOBILIZATION</b>
PPP2	<b>PROMOTING HEALTH EQUITY FOR VULNERABLE POPULATIONS AFFECTED BY ASTHMA AND ALLERGIES</b> <b>E. Ladouceur</b> , Aboriginal Knowledge Translation Assistant, Social Support Research Program, Faculty of Nursing, University of Alberta <b>K. Kara</b> , B.Sc., M.Ed., Research Coordinator, Social Support Research Program, Faculty of Nursing, University of Alberta
PPPS11	<b>ASTHMA PERFORMANCE INDICATORS</b> <b>T. To</b> , PhD, Professor, Dalla Lana Graduate School of Public Health, University of Toronto; Senior Scientist, The Hospital for Sick Children, Research Institute
10:45-11:15 am	<b>BREAK</b>
11:15-11:50 am	<b>GENERAL DISCUSSION</b> Impacts, networking, partnerships, collaborations, legacy opportunities
12:00-1:15 pm	<b>LUNCH</b> <b>CONNECTIONS DINING ROOM</b>
<b>AUDITORIUM</b>	<b>THE CLINICAL INVESTIGATOR COLLABORATIVE (CIC)</b>
1:30-1:45 pm <b>LEAD PRESENTATION</b>	<b>THE CLINICAL INVESTIGATOR COLLABORATIVE (CIC): EVOLUTION AND CURRENT FOCI</b> <b>P. O'Byrne</b> , MB, FRCP(C), FRSC, EJ Moran Campbell Professor and Chair, Department of Medicine, Michael G. DeGroote School of Medicine, McMaster University

1:50-2:45 pm	<b>PANEL F: THE CLINICAL INVESTIGATOR COLLABORATIVE</b>	
<b>CIC-AR</b>	<b>THE CLINICAL INVESTIGATOR COLLABORATIVE: ALLERGIC RHINITIS</b> <b>A. Ellis</b> , MD, M.Sc., FRCPC, Assistant Professor, Department of Biomedical and Molecular Science, Queen's University	
<b>CIC-SA</b>	<b>THE CLINICAL INVESTIGATOR COLLABORATIVE: SEVERE ASTHMA</b> <b>P. Nair</b> , MD, PhD, FRCPC, Associate Professor, Division of Respiriology, McMaster University; Canada Research Chair in Airway Inflammometry	
<b>B&amp;B6</b>	<b>ALLERGIC ASTHMA FUNCTIONAL &amp; PHARMACOGENOMICS FOR EARLY AND LATE PHASE RESPONSE BIOMARKERS</b> <b>S. Tebbutt</b> , PhD, Associate Professor, University of British Columbia	
<b>B&amp;B1</b>	<b>GENOME-WIDE ASSOCIATION RESULTS</b> <b>D. Daley</b> , PhD, Assistant Professor, Department of Medicine, University of British Columbia	
<b>B&amp;B5</b>	<b>URINE NMR-BASED METABOLOMICS FOR ASTHMA DIAGNOSIS</b> <b>D. Adamko</b> , MD, Associate Professor, Department of Pediatrics, University of Saskatchewan	
2:45-3:05 pm	<b>BREAK</b>	
3:05-4:00 pm	<b>GENERAL DISCUSSION</b> Impacts, networking. partnerships, collaborations, legacy opportunities	
6:00-7:30 pm	<b>BBQ DINNER</b>	<b>CONNECTIONS DINING ROOM OUTDOOR PATIO</b>

MONDAY, JUNE 10, 2013

7:30-8:30 am

BREAKFAST

CONNECTIONS DINING ROOM

AUDITORIUM

BIOMARKERS AND BIOINFORMATICS ENABLING PLATFORM

8:40-8:55 am

LEAD  
PRESENTATION**BIOMARKERS FOR ALLERGIC DISEASE AS A CORNERSTONE FOR ALLERGEN'S STRATEGIC PLAN****K. McNagny**, PhD, Interim Co-Director, Biomedical Research Centre, Professor, Department of Medical Genetics, University of British Columbia

9:00-9:45 am

PANEL G: BIOMARKERS AND BIOINFORMATICS

B&amp;B4

**CD34 AS A MUCOSAL INFLAMMATORY ("Stem") CELL DISEASE TARGET****K. McNagny**, PhD, Interim Co-Director, Biomedical Research Centre, Professor, Department of Medical Genetics, University of British Columbia

B&amp;B7

**HEMOPOIETIC STEM CELL BIOMARKERS IN THE DIAGNOSIS AND PREDICTION OF ALLERGIC INFLAMMATION AND DISEASE: STEM (Stem cell Team for Emerging Markers)****J. Denburg**, MD, FRCP(C), Scientific Director and CEO, AllerGen NCE Inc.; Professor of Medicine, Department of Medicine, McMaster University

B&amp;B2

**ANNOTATED DATABASE OF MOLECULAR INTERACTION****F. Brinkman**, PhD, Professor, Simon Fraser University

B&amp;B

**MICROBIOME****A. Kozyrskyj**, PhD, Women & Children's Health Research Institute Chair, Associate Professor, Department of Pediatrics, University of Alberta

PANEL G: BIOMARKERS AND BIOINFORMATICS	
9:45-10:20 am	<b>GENERAL DISCUSSION</b> Impacts, networking, partnerships, collaborations, legacy opportunities
10:20-11:00 am	<b>BREAK</b>
11:00-11:50 am	<b>NETWORK-WIDE AND PROJECT TEAM PRIORITY ACTION ITEMS</b>
12:00-1:10 pm	<b>LUNCH</b> <b>CONNECTIONS DINING ROOM</b>
1:10-1:20 pm	<b>TRANSITION TO FIRST FLOOR NORTH WING-GRAND ROOMS A &amp; B</b>
<b>GRAND ROOMS A &amp; B</b> 1:20-2:20 pm	<b>BREAK-OUT SESSIONS</b> Groups to be determined based on the outcomes of the Network-wide Priority Action Items
2:20-2:55 pm	<b>BREAK-OUT SESSIONS: REPORT BACK</b>
2:55-3:05 pm	<b>CONCLUDING REMARKS</b>

## 2013 SCIENTIFIC MEETING SATELLITE MEETING SCHEDULE

MEETING	DATE	TIME	LOCATION
<b>AQHI MEETING</b> Chair: D. Royce	Sat. June 8	12:15-1:15 pm	Connections Dining Room Reserved table
<b>CHILD TEAM DINNER MEETING</b> Chair: M. Sears	Sat. June 8	6:30-8:00 pm	Grand Room A
<b>CanFAST TEAM MEETING</b> Chair: J. Marshall	Sat. June 8	5:30-6:30pm	Grand Room B
<b>CIC-AR TEAM MEETING</b> Chair: D. Royce	Sun. June 9	8:30-9:30 am	Connections Dining Room Reserved table
<b>CMP-3 TEAM MEETING</b> Chair: T. Takaro	Sun. June 9	4:00-6:00 pm	Grand Room B
<b>CERTIFIED ALLERGY EDUCATOR WORKING GROUP</b> Chair: A. Becker	Mon. June 10	3:30-6:00 pm	Room 20



*Innovation from cell to society  
Innovation de la cellule à la société*

Genes **Allergy Asthma**  
Patients **Discovery** **Commercialization**  
Policy **Mobilization** **Anaphylaxis**  
Biomarkers **Environment**



**Developing**  
new diagnostics, medications,  
patient education tools and  
public policies



**Mobilizing**  
research and results  
to communities  
across Canada



**Reducing**  
morbidity, mortality and the  
socioeconomic impacts of asthma,  
allergy and anaphylaxis

**Commercializing**  
allergy/asthma diagnostics  
and therapeutics



**Uniting**  
Canadian allergy, asthma  
and immune diseases experts  
in a national network



**Training**  
the next generation  
of researchers, innovators  
and clinician-scientists

McMaster  
University



Canada